

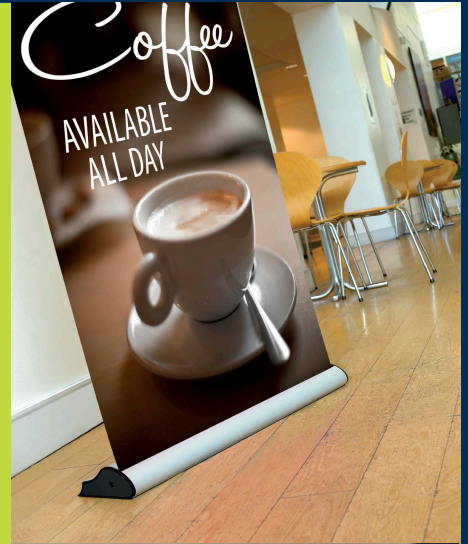

HG|Graphics

Commercial Branding Specialists



BANNERSTANDS

POP-UP SYSTEMS

MODULAR DISPLAYS AND PROMOTION UNITS

LITERATURE STANDS

LIGHTING AND CARRY EQUIPMENT

display



rollerbanners

QUICK REFERENCE GUIDE



PRODUCT SELECTOR

	atom	neo	hex	zeta
PRICE INDICATOR	£	£ £	£ £	£ £
GRAPHIC WIDTH	800/850mm	600/800/850/1000/1200/1500mm	600/800/850/1000/1200/1500mm	800 / 850mm
HANGER TYPE	Gripping	Gripping	Gripping	Mechanical
POLE TYPE	3 part bungee	3 part bungee* *600mm pole has a 4 part bungee	3 part bungee* *600mm pole has a 4 part bungee	Telescopic
	PAGE 6	PAGE 6	PAGE 7	PAGE 6



N.B Photo not to scale

PRODUCT SELECTOR

	genie	sigma	sidewinder	omega	bantam
PRICE INDICATOR	£ £ £	£ £ £	£ £ £ £	£ £ £ £	£
GRAPHIC WIDTH	800/1000mm	800/1000mm	600/800/1000/1200/1500mm	780mm [fabric]	297mm
HANGER TYPE	Gripping	Mechanical	Self-adhesive	N/A	Self-adhesive
POLE TYPE	3 part bungee	Telescopic	4 part bungee	3 part bungee	2 part steel pole
	PAGE 8	PAGE 8	PAGE 9	PAGE 10	PAGE 10

NOTE: Hardware only no graphics included.

atom

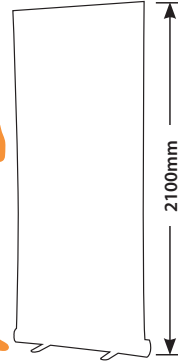

800mm footprint: 815 [w] x 380 [d]mm
850mm footprint: 865 [w] x 380 [d]mm

CODE	DESCRIPTION
91756	Atom 800mm
91757	Atom 850mm

features

- Entry level roller banner
- 800mm and 850mm widths, single-sided
- Visible graphic height 1990mm
- Sure grip, slim profile, gripping hanger
- Strong, fixed height, 3 part bungeed pole set
- Two twist out feet
- Canvas carry bag included
- Unbranded instructions and packaging
- 1m adhesive hook fastener included

neo

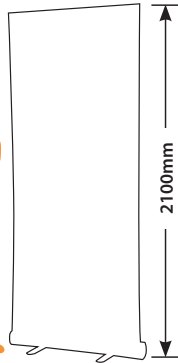
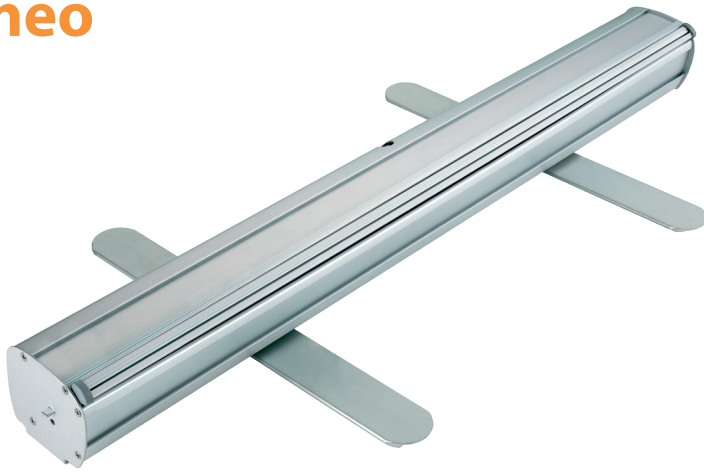

600mm footprint: 615 [w] x 380 [d]mm
800mm footprint: 815 [w] x 380 [d]mm
850mm footprint: 865 [w] x 380 [d]mm
1000mm footprint: 1015 [w] x 380 [d]mm
1200mm footprint: 1215 [w] x 380 [d]mm
1500mm footprint: 1515 [w] x 380 [d]mm

CODE	DESCRIPTION
91825	Neo 600mm wide
91754	Neo 800mm wide
91755	Neo 850mm wide
91826	Neo 1000mm wide
91827	Neo 1200mm wide
91828	Neo 1500mm wide

features

- Thicker aluminium extrusions for main unit and feet
- Sure grip, slim profile, gripping hanger
- Strong, fixed height, 3 part bungeed pole set*
- Single-sided, available in 6 widths
- Two twist out feet
- Unbranded instructions and packaging
- Padded carry bag
- Individually boxed

*Pole for Neo 600mm unit is a 4 part bungeed pole set.

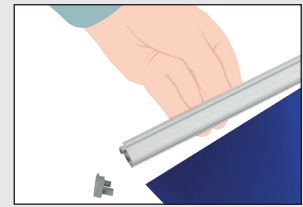

Sure grip hanger.



Fixed height bungeed pole set.

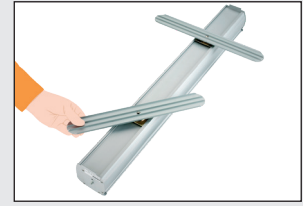

Two twist out feet.

GRAPHIC PANEL SIZES

- **Finished size:** 2200 x 800/850mm [inc. 200mm bleed]
- **Visual area:** 1990 x 800/850mm [top 10mm of graphic hidden by the top gripper rail]



Thicker end cap.



Padded bag.



Individually boxed.

GRAPHIC PANEL SIZES

- **Finished size:** 2200 x 600/800/850/1000/1200/1500mm [inc. 200mm bleed]
- **Visual area:** 1990 x 600/800/850/1000/1200/1500mm [top 10mm of graphic hidden by the top gripper rail]



Stylish embossed black plastic end caps.



Two twist out feet.



Padded bag and individually boxed.

GRAPHIC PANEL SIZES

- **Finished size:**
2115 x 600/800/850/1000/1200/1500mm [inc. 110mm bleed]
- **Visual area:**
2005 x 600/800/850/1000/1200/1500mm [top 10mm if graphic hidden by the top gripper rail]

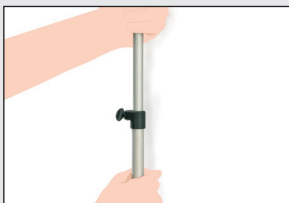

Adjustable telescopic pole set.

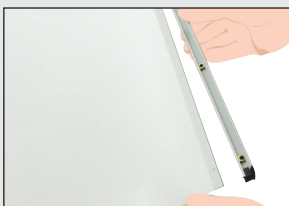

Mechanical style top hanger.



Can be used as a desktop system.

GRAPHIC PANEL SIZES

- **Finished size:**
2300 x 800/850mm [inc. 200mm bleed]
- **Visual area:**
2090 x 800/850mm [top 10mm of graphic hidden by the mechanical hanger]

hex

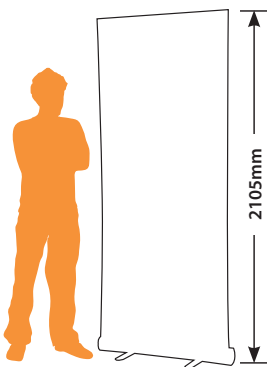

ONE-YEAR WARRANTY **1**

600mm footprint: 620 [w] x 320 [d]mm
800mm footprint: 820 [w] x 320 [d]mm
850mm footprint: 870 [w] x 320 [d]mm

1000mm footprint: 1020 [w] x 320 [d]mm
1200mm footprint: 1220 [w] x 320 [d]mm
1500mm footprint: 1520 [w] x 320 [d]mm

CODE	DESCRIPTION
91890	Hex 600mm wide
91891	Hex 800mm wide
91892	Hex 850mm wide
91893	Hex 1000mm wide
91894	Hex 1200mm wide
91895	Hex 1500mm wide

features

- Single-sided available in six widths
- Gripper rail top hanger
- Two twist out feet
- Strong fixed height, 3 part bungeed pole set*
- Compatible with Plex light fitting
- Padded carry bag included
- Individually boxed

*Hex 1200mm & 1500mm wide have 2 part bungeed pole set.

zeta

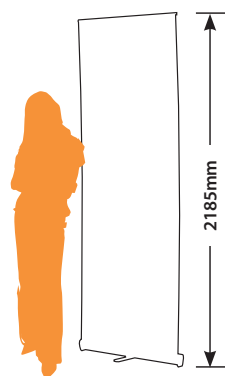

TWO-YEAR WARRANTY **2**

Footprint: 810 [w] x 320 [d]mm
Footprint: 860 [w] x 320 [d]mm

CODE	DESCRIPTION
91080	Zeta 800mm wide
91843	Zeta 850mm wide

features

- Budget roller banner
- 800/850mm wide, single-sided
- Visible graphic height to maximum 2090mm
- Mechanical style top hanger
- Tension adjustment
- Telescopic poles, adjust from 730mm to 2100mm
- Twist out foot
- Padded carry bag included
- Individually boxed

genie



CODE	DESCRIPTION
30241	Genie 800mm wide
90843	Genie 1000mm wide

features

- 800mm and 1000mm widths
- Single-sided
- Visible graphic height 2100mm
- Tension adjustment
- Fixed height bungeed pole set
- Quick change graphic facility
- Padded carry bag included
- Individually boxed



Quick change graphic facility.



Available in 800mm and 1000mm widths.

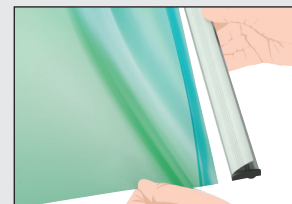

Gripper style top hanger.

GRAPHIC PANEL SIZES

- **Finished size:**
2315 x 800/1000mm
[inc. 200mm bleed]
- **Visual area:**
2100 x 800/1000mm
[top 15mm of graphic hidden by the top gripper rail]

sigma



CODE	DESCRIPTION
91444	Sigma 800mm wide
91739	Sigma 1000mm wide

features

- 800 and 1000mm widths, single-sided
- Telescopic poles adjust from 730 - 2100mm
- Mechanical style top hanger
- Tension adjustment
- Quick change graphic facility
- Weighted anti-slip base
- Padded carry bag included
- Individually boxed

NOTE: Hardware only no graphics included.



Telescopic marked pole set.



Can be used as a desktop system.

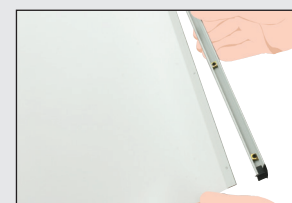

Mechanical hanger.

GRAPHIC PANEL SIZES

- **Finished size:**
2300 x 800/1000mm
[inc. 200mm bleed]
- **Visual area:**
2090 x 800/1000mm
[top 10mm of graphic hidden by the mechanical hanger]



Integral bungeed pole set.

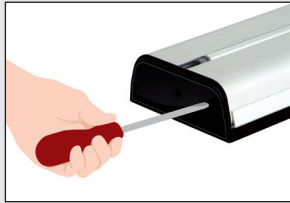

Adjustable tensioning [if required].



Available in single or double-sided options.

GRAPHIC PANEL SIZES

- **Finished size:**
2300 x 600/800/1000/1200/
1500mm [inc. 200mm bleed]
- **Visual area:**
2100 x 600/800/1000/
1200/1500mm

sidewinder

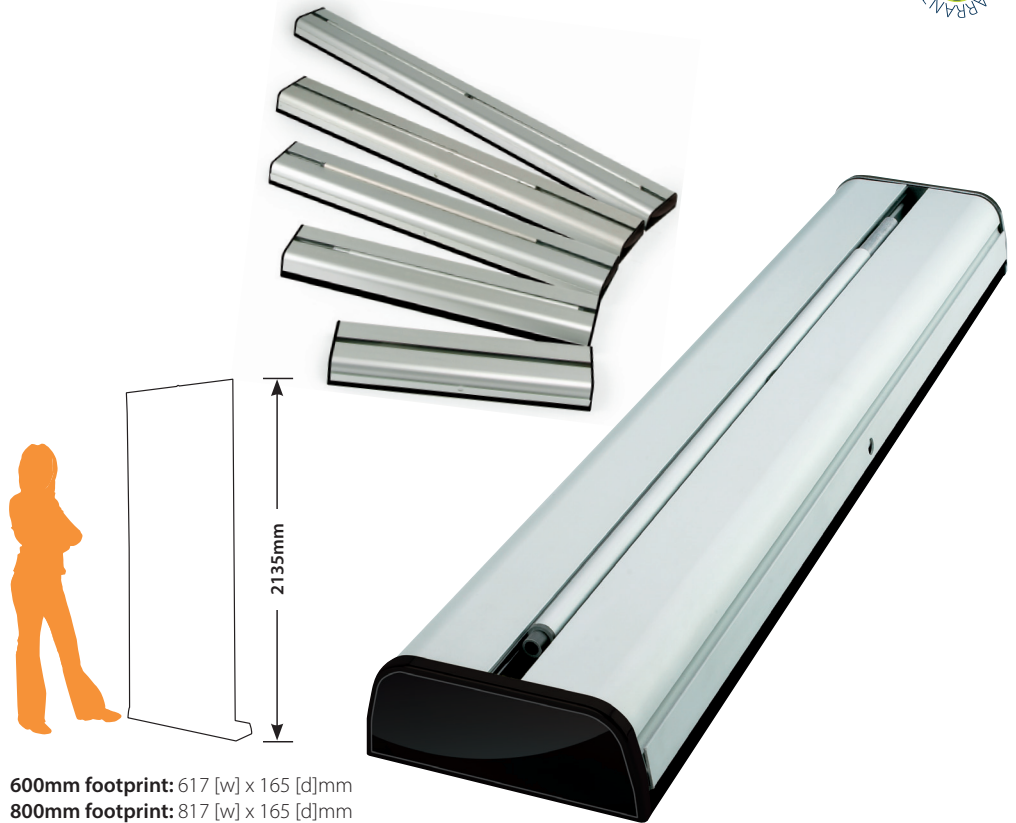

- **600mm footprint:** 617 [w] x 165 [d]mm
- **800mm footprint:** 817 [w] x 165 [d]mm
- **1000mm footprint:** 1017 [w] x 165 [d]mm
- **1200mm footprint:** 1217 [w] x 165 [d]mm
- **1500mm footprint:** 1517 [w] x 165 [d]mm

features and benefits

- Never lose your pole set again with Sidewinder's integral pole design
- A size option to suit any location. A truly versatile range of 5 widths – 600mm, 800mm, 1000mm, 1200mm and 1500mm wide. All sizes available as either single or double-sided
- Unique full graphic appearance - your message is the only thing you see when the system is assembled
- A deluxe carry bag with 30mm thick padded ends means the Sidewinder can be transported regularly without any worry of damage
- Self-adhesive top hanger
- The graphic can be changed quickly and easily due to the hook and loop fastener fixing method
- Fixed height poles allow the graphic to be rapidly set-up to the correct height every time
- The patented adjustable ratchet mechanism enables the graphic tension to be adjusted to suit each graphic substrate (if required)
- Anti-slip base
- Individually boxed

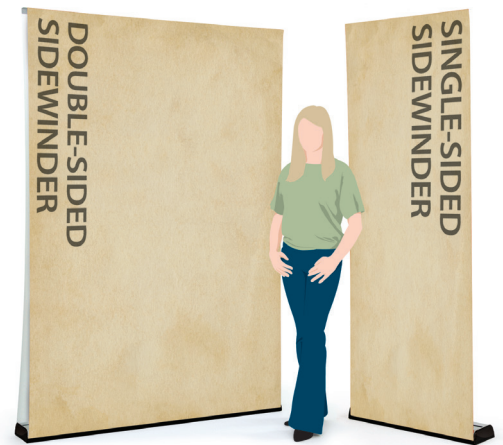

UK Patent No. WO 02/057588
No. PCT/GB02/00129 in USA

CODE	DESCRIPTION
463010	Sidewinder 600mm / single-sided
463011	Sidewinder 800mm / single-sided
463012	Sidewinder 1000mm / single-sided
463013	Sidewinder 1200mm / single-sided
463014	Sidewinder 1500mm / single-sided
463020	Sidewinder 600mm / double-sided
463021	Sidewinder 800mm / double-sided
463022	Sidewinder 1000mm / double-sided
463023	Sidewinder 1200mm / double-sided
463024	Sidewinder 1500mm / double-sided

PLEASE NOTE: Unattached pole set on 600mm version.

omega



Footprint: 875 [w] x 465 [d]mm

CODE	DESCRIPTION
30225/1	Omega fabric 780mm / grey fabric
30225/4	Omega fabric 780mm / blue fabric
30225/5	Omega fabric 780mm / black fabric
30225/7	Omega fabric 780mm / red fabric

features

- Supplied with a choice of four Velcro® friendly fabric colours (grey, blue, black and red)
- 780mm wide, single-sided
- Visible fabric height 2000mm
- Fixed height bungeed pole set
- Customisable end trims
- Carry bag included
- 1m adhesive hook fastener included

bantam



Footprint: 325 [w] x 78[d]mm

CODE	DESCRIPTION
91900	Bantam A3 desktop roller banner

features

- Single-sided A3 graphic size
- Aluminium base with chrome plated plastic ends
- 2 part steel pole
- Self-adhesive top rail and leader
- Individually boxed

NOTE: Hardware only no graphics included.



Customisable end trims.



Velcro® friendly fabric panels.

FABRIC COLOUR OPTIONS:



Chrome Grey

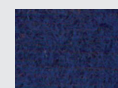

Sapphire Blue

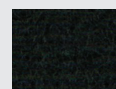

Charcoal Black

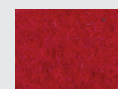

Chilli Pepper Red



Fabric is manufactured from recycled materials.

FABRIC PANEL SIZES

- **Visible fabric area:**
2000 x 780mm



Perfect for counter display.

GRAPHIC PANEL SIZES

- **Finished size:**
297 x 435mm
[inc. 15mm bleed]
- **Visual area:**
297 x 420mm

staticbanners

QUICK REFERENCE GUIDE



PRODUCT SELECTOR

PRICE INDICATOR

VISUAL GRAPHIC AREA

GRAPHIC ATTACHMENT METHOD

POLE TYPE

cobra

PRICE INDICATOR	£
VISUAL GRAPHIC AREA	2072 x 800mm
GRAPHIC ATTACHMENT METHOD	Gripping hangers
POLE TYPE	Telescopic

PAGE 12

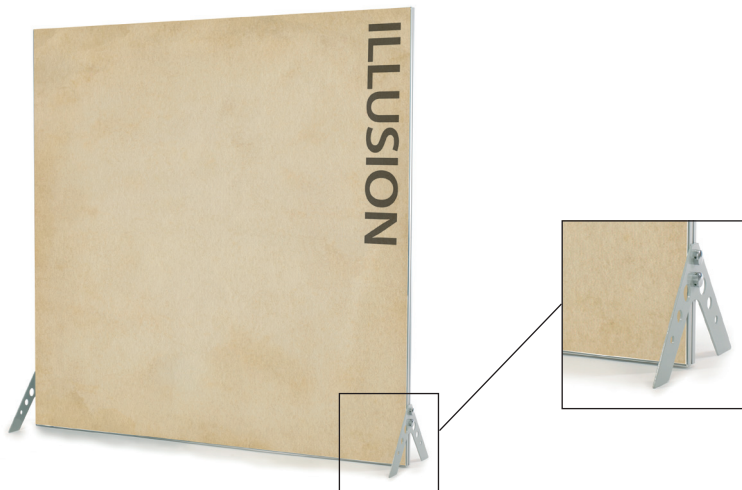

PRODUCT SELECTOR

PRICE INDICATOR

VISUAL GRAPHIC AREA

GRAPHIC ATTACHMENT METHOD

FOOTPRINT

illusion

PRICE INDICATOR	£ £ £ £
VISUAL GRAPHIC AREA	2000 x 2000mm
GRAPHIC ATTACHMENT METHOD	Stitched Silicone strip
FOOTPRINT	2040 [w] x 495 [d]mm

PAGE 12

NOTE: Hardware only no graphics included.

cobra

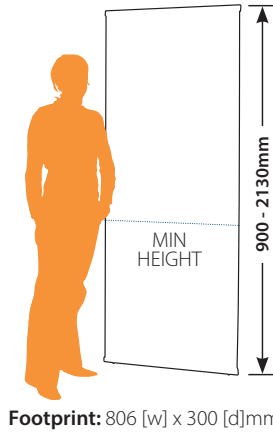

CODE	DESCRIPTION
91065	Cobra 800mm wide

features

- 800mm wide, single-sided
- Visible graphic height adjusts from 900mm up to 2000mm
- Adjustable telescopic pole set
- Gripper style top and bottom hangers
- Lightweight carry box included
- Can be used as a desktop system
- Assembled weight 2.0kg



Quick and easy graphic change with the gripper style hanger.



Adjustable telescopic pole set, can be used as desktop system.



Weighted base for added stability.

GRAPHIC PANEL SIZES

- **Finished size:** 2100 x 800mm
- **Visual area:** 2072 x 800mm [14mm hidden at the top and bottom by the gripper hangers]

illusion

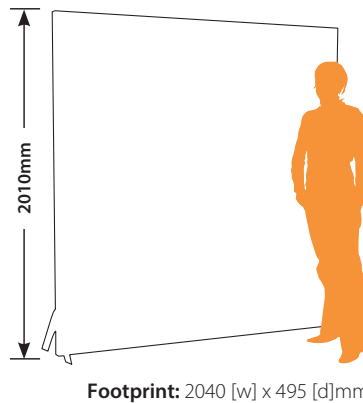

CODE	DESCRIPTION
91645	Illusion 2000mm wide
91657	Replacement graphic/ double-sided conversion silicone strip

features

- Visible graphic area 2000 x 2000mm
- Single-sided as standard
- Turn a single-sided kit into a double-sided by adding extra silicone strip
- Heavy steel triangular feet for stability
- Kit includes: frame, steel weighted feet and silicone graphic strip (enough for one graphic)
- Matt knitted polyester recommended substrate

NOTE: Hardware only no graphics included.

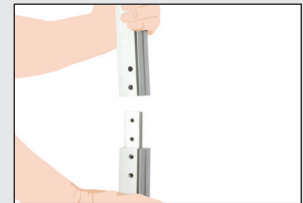

Push fit frame construction.

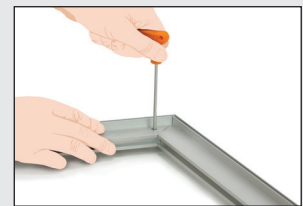

Corners assemble easily with an Allen key [supplied with kit].

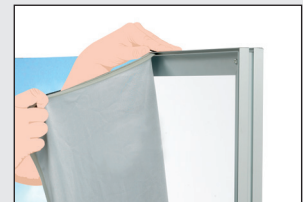

The silicone graphic strip sits tightly in the frame. Graphic stretches into place.

GRAPHIC PANEL SIZES

- **Finished size:** 2000 x 2000mm
- **Visual area:** 2000 x 2000mm

outdoorbanners

QUICK REFERENCE GUIDE



nimbus



polar



typhoon

PRODUCT SELECTOR

PRICE INDICATOR	£	£ £	£ £ £ £
WEIGHT [WITHOUT / WITH WATER]	2kg / 18kg	4.3kg / 22.3kg	15kg / 41kg
HEIGHT	2000mm	1350 - 2150mm [telescopic]	2170mm
FOOTPRINT	600 [w] x 630 (S/S) 740 (D/S) [d]mm	650 - 800mm [w] x 400 [d]mm [adjustable width]	1000 [w] x 780 [d]mm

PAGE 14

PAGE 14

PAGE 15



outdoor A-banner



vision

PRODUCT SELECTOR

PRICE INDICATOR	£ £	£ £ £
WEIGHT	2000mm = 3.8kg / 3000mm = 5.5kg	2000mm single-sided = 5.5kg / 3000mm single-sided = 7.2kg 2000mm double-sided = 8.5kg / 3000mm double-sided = 12.1kg
HEIGHT	960mm	1100mm
FOOTPRINT	2000mm = 2200 [w] x 650 [d]mm 3000mm = 3190 [w] x 650 [d]mm	2000mm = 2140 [w] x 990 [d]mm 3000mm = 3160 [w] x 990 [d]mm

PAGE 15

PAGE 16

NOTE: Hardware only no graphics included.

nimbus

NEW

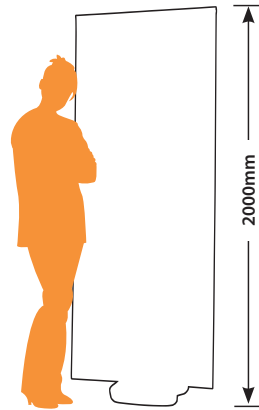

Footprint: 600 [w] x 630 (s/s) 740 (d/s) [d]mm



CODE	DESCRIPTION
92005	Nimbus outdoor bannerstand / single-sided
92006	Nimbus outdoor bannerstand / double-sided
91281	Polar / Nimbus carry bag set
91282	Polar / Nimbus weighted base ring

features

- Accepts graphic widths 500 - 600mm
- Accepts graphic heights 1600 - 1800mm
- Single or double sided options available
- Ideally suited to eyeletted PVC or mesh substrates
- 15.5 litre base capacity
- Optional carry bag set available
- Optional weighted base ring (10 litre capacity)

I Graphics suitable for outdoor use are recommended.

polar

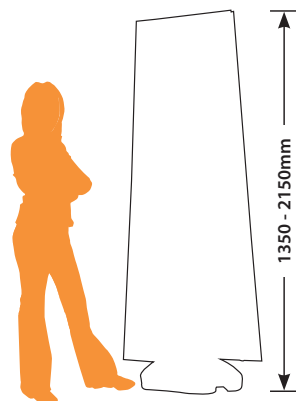
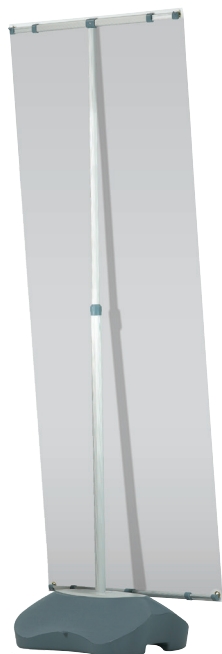

Footprint: 650 - 800 [w] x 400 [d]mm



CODE	DESCRIPTION
91240	Polar outdoor bannerstand
91282	Polar / Nimbus weighted base ring
91281	Polar / Nimbus carry bag set

features

- Adjustable graphic width from 650 to 800mm
- Adjustable graphic height from 1200 to 2000mm
- Single or double-sided option as standard
- Ideally suited to eyeletted PVC or mesh substrates
- 18 litre base capacity
- Optional carry bag set available
- Optional weighted base ring (10 litre capacity)

I Graphics suitable for outdoor use are recommended.

NOTE: Hardware only no graphics included.



Moulded base can be filled with water or sand for added stability.



Thick, secure, sturdy main pole with locking lever.



Moulded hooks allow easy graphic attachment.

GRAPHIC PANEL SIZES

- **Finished size:**
1600-1800 x 500-600mm
- **Visual area:**
1600-1800 x 500-600mm



Adjustable telescopic pole set.

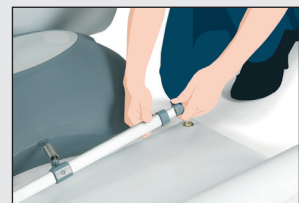

Adjustable width graphic hangers.



Moulded plastic base can be filled with water or sand for extra stability. Optional weighted base ring is available.

GRAPHIC PANEL SIZES

- **Finished size:**
1200-2000 x 650-800mm
- **Visual area:**
1200-2000 x 650-800mm



Water/sand filled base with twist out foot for added stability.



Pull handle and integral wheels for easy transportation.

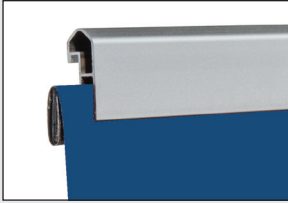

Wrap around slide-in self-adhesive hanger. Please follow instructions exactly as published.

GRAPHIC PANEL SIZES

- **Finished size:**
2150 x 800mm
[inc. 100mm bleed]
- **Visual area:**
2000 x 800mm
[50mm hidden by wrapping
around adhesive hanger insert]

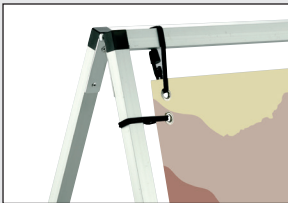

Push fit parts give quick and easy assembly.

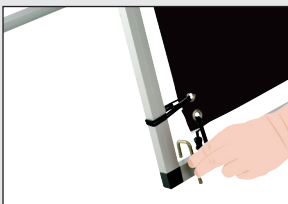

Ground pegs supplied as standard for use in soft ground.

GRAPHIC PANEL SIZES

- **Finished size:**
2000/3000 x 800mm
- **Visual area:**
2000/3000 x 800mm

typhoon

TWO-YEAR WARRANTY

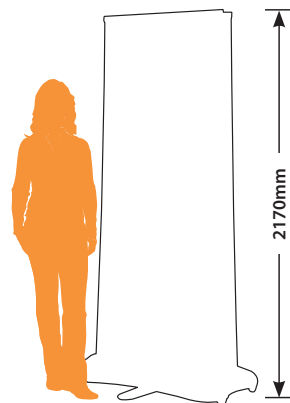

Footprint: 1000 [w] x 780 [d]mm



CODE	DESCRIPTION
91634	Typhoon 800mm outdoor roller bannerstand

features

- 800mm wide, single or double-sided outdoor roller banner
- Choice of visual graphic height either 1470 or 2000mm. Lift lever to unlock graphic.
- Wheeled base for easy manoeuvrability
- Two wrap around slide-in self-adhesive top hangers supplied as standard
- 26 litre base capacity
- Carry bag included

[i] Graphics suitable for outdoor use are recommended.

outdoor A-banner

ONE-YEAR WARRANTY

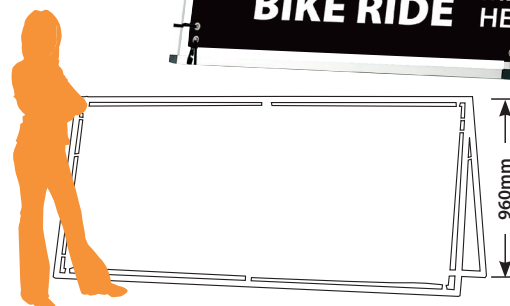

2m footprint: 2200 [w] x 650 [d]mm

3m footprint: 3190 [w] x 650 [d]mm



CODE	DESCRIPTION
91716	Outdoor A-banner 2m / single/double-sided
91717	Outdoor A-banner 3m / single/double-sided

features

- Two widths available – 2m and 3m
- 2m and 3m widths can be used as either single or double-sided
- Graphic height – 800mm
- Graphic width – 2000mm or 3000mm
- Push fit assembly
- Flexible bungee cord graphic attachment
- Ideally suited to eyeletted PVC or mesh substrates
- Carry bag included
- Ground pegs included

[i] Graphics suitable for outdoor use are recommended.

vision

TWO-YEAR WARRANTY

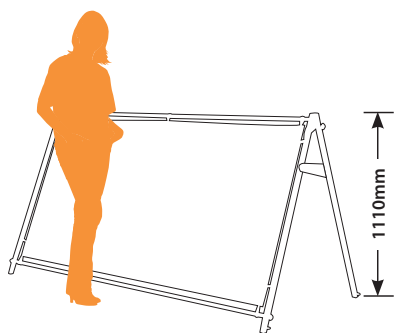

1110mm



2m footprint: 2140 [w] x 990 [d]mm

3m footprint: 3160 [w] x 990 [d]mm

CODE	DESCRIPTION
91998	Vision 2000mm / single-sided
92000	Vision 2000mm / double-sided
91999	Vision 3000mm / single-sided
92001	Vision 3000mm / double-sided
91778	Carry Bag

features

- Screw fit, horizontal, anodised aluminium poles for increased rigidity
- Two widths available - 2m and 3m
- 2m and 3m wide available in both single or double-sided
- Graphic height - 1000mm
- Flexible bungee cord graphic attachment
- Ideally suited to eyeletted PVC or mesh substrates
- Graphics for outdoor use are recommended
- Optional carry bag available
- Ground pegs included
- Folds flat for easy storage

I Graphics suitable for outdoor use are recommended.



Robust screw fit assembly ideal for outdoor environments.

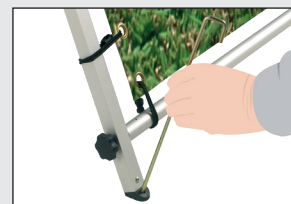

Ground pegs supplied as standard for use in soft ground.

GRAPHIC PANEL SIZES

- **Finished size:**
1000 x 2000/3000mm
- **Visual area:**
1000 x 2000/3000mm



NOTE: Hardware only no graphics included.



THE
OLD LEATHER
BOOT

HAPPY
HOUR

£2.30
PER PINT

£1.80
PER PINT

£2.00
PER PINT

FRIDAYS FROM 7PM - 8PM

pavementsignage

QUICK REFERENCE GUIDE



PRODUCT SELECTOR

	sign wedge	folding swing sign	classic swing sign	switch swing sign
PRICE INDICATOR	£	£	£ £	£ £
WEIGHT	6.1kg	5.9kg	10.5kg	10.5kg
HEIGHT	795mm	846mm	915mm	915mm
PANEL SIZE	780 [h] x 410 [w]mm	750 [h] x 500 [w]mm	750 [h] x 500 [w]mm	594 [h] x 420 [w]mm <i>Holds A2 poster</i>
FOOTPRINT	420 [w] x 420 [d]mm	585 [w] x 585 [d]mm	585 [w] x 460 [d]mm	585 [w] x 460 [d]mm

PAGE 36

PAGE 36

PAGE 37

PAGE 37



PRODUCT SELECTOR

	aquabase prime	aquabase swap	A-frame
PRICE INDICATOR	£ £ £	£ £ £	£ £
WEIGHT	11.0kg 41.0kg with water	11.0kg 41.0kg with water	A0 = 17kg / A1 = 10.5kg / A2 = 6.8kg
HEIGHT	1215mm	1215mm	A0 = 1445mm / A1 = 1165mm / A2 = 985mm
PANEL SIZE	990 [h] x 640 [w]mm	841 [h] x 594 [w]mm <i>Holds A1 poster</i>	A0 = 1189 [h] x 841 [w] / A1 = 841 [h] x 594 [w] / A2 = 594 [h] x 420 [w]mm
FOOTPRINT	740 [w] x 610 [d]mm	740 [w] x 610 [d]mm	A0 = 883 [w] x 805 [d] / A1 = 625 [w] x 670 [d] / A2 = 465 [w] x 680 [d]mm

PAGE 38

PAGE 38

PAGE 39

NOTE: Hardware only no graphics included.

sign wedge

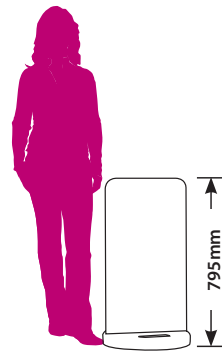

Footprint: 420 [w] x 420 [d]mm

CODE	DESCRIPTION
40398	Sign wedge
80263	Replacement sign blank

features

- Double-sided graphic area
- White printable aluminium sign blank
- Printable graphic area 740 x 410mm
- Recycled PVC base
- Quick and easy assembly, no tools required
- Hand holes in base
- Graphic friction fits into base

Graphics suitable for outdoor use are recommended.

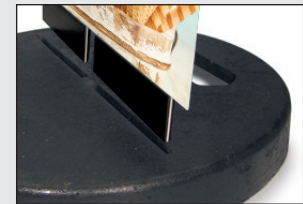

Aluminium graphic panel friction fits into base.



Heavy duty circular recycled PVC base with hand holes for easy transportation.

GRAPHIC PANEL SIZES

- **Blank size:**
780 x 410mm [top corners have a radius of 50mm]
- **Visual area:**
740 x 410mm [top corners have a radius of 50mm]

folding swing sign

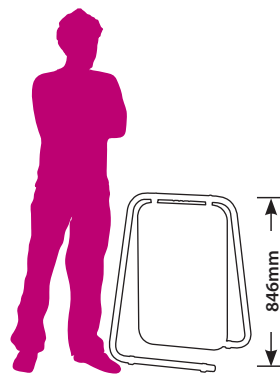

Footprint: 585 [w] x 585 [d]mm

CODE	DESCRIPTION
91753	Folding swing sign
80267	Replacement sign blank

features

- No assembly required
- Folds flat for storage
- Easy to handle when folded flat
- White printable aluminium sign blank
- Printable graphic area 750 x 500mm
- Simple, yet sturdy design

Graphics suitable for outdoor use are recommended.

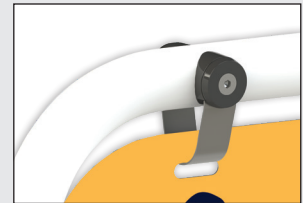

Stainless steel tamper proof hanging clips.

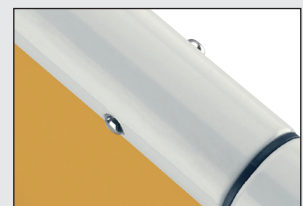

Spring button allows frame to fold flat.

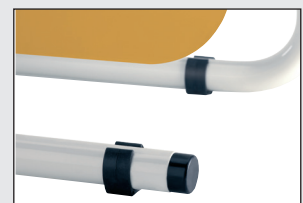

Robust black plastic feet.

GRAPHIC PANEL SIZES

- **Blank size:**
750 x 500mm [corners have a radius of 75mm]
- **Visual area:**
750 x 500mm [corners have a radius of 75mm]



Frames available in white, black or grey.

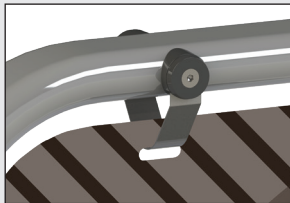

Stainless steel tamper proof hanging clips.



Robust frame secures into heavy duty recycled PVC Base.

GRAPHIC PANEL SIZES

- **Blank size:**
750 x 500mm [corners have a radius of 75mm]
- **Visual area:**
750 x 500mm [corners have a radius of 75mm]



Magnetic poster pocket holds A2 graphic posters.



Frames available in white, black or grey.



Stainless steel tamper proof hanging clips.

GRAPHIC PANEL SIZES

- **Poster size:**
A2 – 594 x 420mm
- **Visual area:**
575 x 400mm

classic

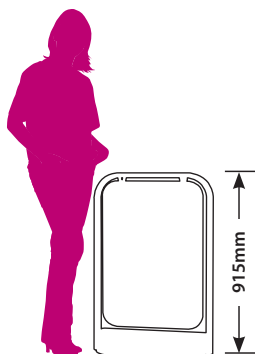

Footprint: 585 [w] x 460 [d]mm



CODE	DESCRIPTION
40404	Classic swing sign / white frame
40405	Classic swing sign / black frame
91817	Classic swing sign / grey frame
80267	Replacement sign blank

features

- Double-sided graphic area
- White printable aluminium sign blank
- Printable graphic area 750 x 500mm
- Frame available in white, black or grey
- Recycled PVC base
- Quick and easy assembly, no tools required

I Graphics suitable for outdoor use are recommended.

switch

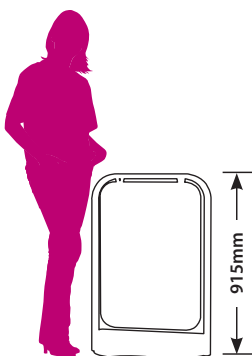

Footprint: 585 [w] x 460 [d]mm



MIX'N'MATCH
frame and pocket
colours contact us
for details

CODE	DESCRIPTION
40402	Switch swing sign / white frame / white poster pocket
40403	Switch swing sign / black frame / black poster pocket
91818	Switch swing sign / grey frame / grey poster pocket

features

- Double-sided magnetic A2 poster pocket with printable header section
- Frame and poster pocket available in white, black or grey
- Houses A2 poster (594 x 420mm)
- Recycled PVC base
- Quick and easy assembly, no tools required

I Graphics suitable for outdoor use are recommended.

NOTE: Hardware only no graphics included.

aquabase prime

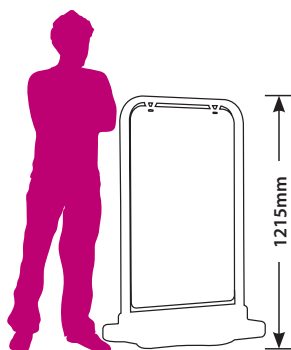

Footprint: 740 [w] x 610 [d]mm

CODE	DESCRIPTION
91819	Aquabase prime / white frame
91820	Aquabase prime / black frame
91821	Aquabase prime / grey frame
91811	Replacement sign blank

features

- Double-sided graphic area
- White printable aluminium sign blank
- Printable graphic area 990 x 640mm
- Quick and easy assembly
- Frame available in white, black or grey
- Robust frame and water fillable base give great stability even in adverse weather conditions
- Wheels in base allow unit to be manoeuvred into position
- Base capacity 30 litres

! Graphics suitable for outdoor use are recommended.

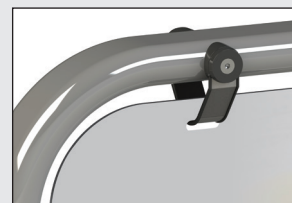

Stainless steel tamper proof hanging clips.



Wheeled base for easy manoeuvrability.



Water or sand can be used to fill base.

GRAPHIC PANEL SIZES

- **Blank size:**
990 x 640mm [corners have a radius of 75mm]
- **Visual area:**
990 x 640mm [corners have a radius of 75mm]

aquabase swap



MIX'N'MATCH
frame and pocket
colours contact us
for details

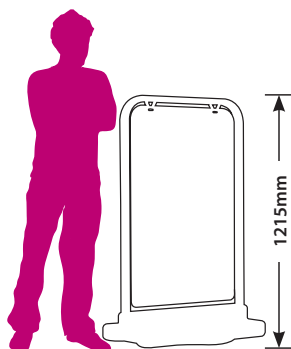

Footprint: 740 [w] x 610 [d]mm

CODE	DESCRIPTION
91814	Aquabase Swap swing sign / white frame
91815	Aquabase Swap swing sign / black frame
91816	Aquabase Swap swing sign / grey frame

features

- Double-sided magnetic A1 poster pocket (841 x 594mm) with printable header section
- Frame and poster pocket available in three colours:- white, black and grey
- Quick and easy assembly
- Robust frame and water fillable base give great stability even in adverse weather conditions
- Wheels in base allow unit to be manoeuvred into position
- Base capacity 30 litres

! Graphics suitable for outdoor use are recommended.



Magnetic poster pocket holds A1 graphic or poster.

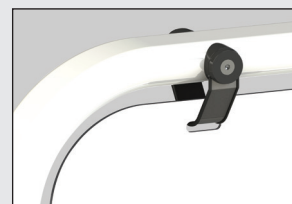

Stainless steel tamper proof hanging clips.



Wheeled base for easy manoeuvrability.

GRAPHIC PANEL SIZES

- **Poster size:**
A1 - 841 x 594mm
- **Visual area:**
814 x 575mm



Rounded chrome corners.



Secure locking arms.

A-frame

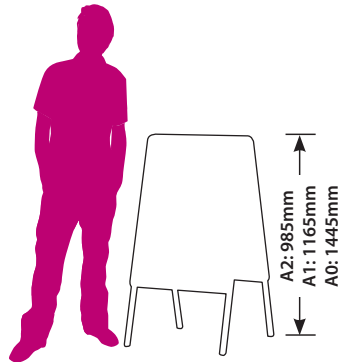

A2 footprint: 465 [w] x 680 [d]mm

A1 footprint: 625 [w] x 670 [d]mm

A0 footprint: 883 [w] x 805 [d]mm



GRAPHIC PANEL SIZES

• Finished size:

A2 – 594 x 420mm

A1 – 841 x 594mm

A0 – 1189 x 841mm

• Visual area:

A2 – 574 x 400mm

A1 – 821 x 574mm

A0 – 1169 x 821mm

CODE	DESCRIPTION
90621	A2 A-frame / double-sided
90620	A1 A-frame / double-sided
90619	A0 A-frame / double-sided

features

- Double-sided
- Easy change snapframe mechanism securely holds posters in place
- Galvanised steel backing adds weight and strength
- Houses posters in A0 (1189 x 841mm), A1 (841 x 594mm) and A2 (594 x 420mm)
- 32mm wide aluminium snapframe
- Comes complete with protective front corners

I Graphics suitable for outdoor use are recommended.



NOTE: Hardware only no graphics included.

LO-COST

In-store | Online | Mobile

2 for
£2

Don't
flake out at
breakfast.



Find our offers

In-store | Online | Mobile

plex



LO-COST

2 for
£7

Don't
flake out at
breakfast.



Find our offers
In-store | Online | Mobile

forecourtsignage

QUICK REFERENCE GUIDE



**A1 H2O
swingmaster**

**PRODUCT
SELECTOR**

PRICE INDICATOR



GRAPHIC SIZE

A1 = [841 x 594mm]

DIMENSIONS

A1 = 1150 [h] x 780 [w] x 500 [d]mm

BASE CAPACITY

A1 = 26 litres

PAGE 42



**A0 H2O
swingmaster**



A0 = [1189 x 841mm]

A0 = 1530 [h] x 1030 [w] x 650 [d]mm

A0 = 50 litres

PAGE 42



icon

**PRODUCT
SELECTOR**

PRICE INDICATOR



GRAPHIC SIZE

A1 = [841 x 594mm]

DIMENSIONS

A1 = 1215 [h] x 740 [w] x 610 [d]mm

BASE CAPACITY

A1 = 30 litres

PAGE 43



icon plus



A0 = [1189 x 841mm]

A0 = 1633 [h] x 986 [w] x 841 [d]mm

A0 = 70 litres

PAGE 43



icon max



60" x 40" = [1016 x 1524mm]

60" x 40" = 2006 [h] x 1161 [w] x 1000 [d]mm

60" x 40" = 108 litres

PAGE 44

NOTE: Hardware only no graphics included.

H2O swingmaster



Posters are secured by 32mm aluminium snapframe profile.



Wheeled base for easy manoeuvrability.



Weighted base can be filled with water or sand for extra stability.



Reinforced corners on heavy duty A0 version.

CODE	DESCRIPTION
91708	A1 H2O swingmaster
91945	A0 H2O heavy duty swingmaster



GRAPHIC PANEL SIZES

- **Finished size:**
A1 – 841 x 594mm
A0 – 1189 x 841mm
- **Visual area:**
A1 – 827 x 580mm
A0 – 1175 x 827mm

features

- Double-sided outdoor forecourt sign, available in two sizes, A0 and A1
- Steel reinforced rounded corners, heavy duty A0
- Protective pads stop damage to underside of base
- Quick and easy assembly, no tools required
- Wheels in base allow unit to be manoeuvred into position
- Water fillable base gives great stability even in adverse weather conditions
- Base capacity; A1 – 26 litres and A0 – 50 litres

Graphics suitable for outdoor use are recommended.

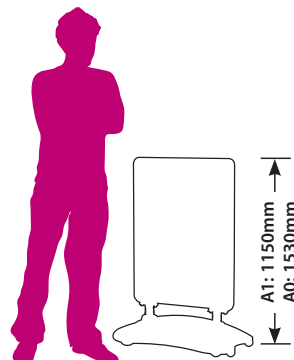

A1 footprint: 780 [w] x 500 [d]mm
A0 footprint: 1030 [w] x 650 [d]mm

the icon range

THE PREMIER PAVEMENT AND FORECOURT SIGN

features for all icons

- Tough polyethylene moulded header with graphic recess.
- Poster hanging clips - hold poster in correct position.
- Strong steel frame.
- Built in wheels for ease of movement. Optional trolley available for Max and Plus size.
- Tough water-fillable polyethylene base.
- Unique hinged poster cover - allows quick poster changes.
- Your communication here.
- Poster insertion instructions printed onto backboard.
- Recyclable at end of life, part manufactured from recycled materials.
- Anti-scoff features designed into underside of base.



icon

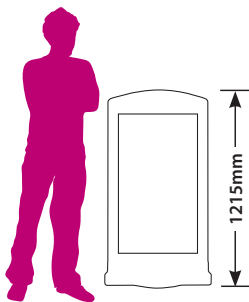

Footprint: 740 [w] x 610 [d]mm

ADDITIONAL FEATURES FOR ICON

- 50kg Assembled weight - when base filled with water
- Steel galvanised backboard

GRAPHIC PANEL SIZES

- Finished size: 841 x 594mm
- Visual area: 814 x 577mm

icon plus

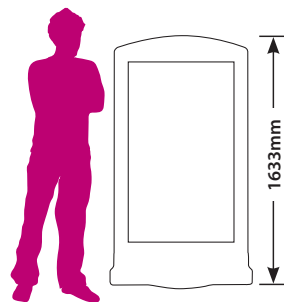

Footprint: 986 [w] x 814 [d]mm

ADDITIONAL FEATURES FOR ICON PLUS

- 102kg Assembled weight - when base filled with water
- Strong, but lightweight corrugated plastic backboard

GRAPHIC PANEL SIZES

- Finished size: 1189 x 841mm
- Visual area: 1162 x 824mm

icon max

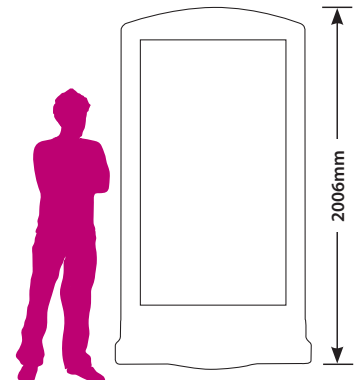

Footprint: 1161 [w] x 1000 [d]mm

ADDITIONAL FEATURES FOR ICON MAX

- 151kg Assembled weight - when base filled with water
- Strong, but lightweight corrugated plastic backboard

GRAPHIC PANEL SIZES

- Finished size: 60" x 40" (1524 x 1016mm)
- Visual area: 1497 x 999mm



CODE	DESCRIPTION
30333	Icon A1 sign
92050	Icon plus A0 sign
91930	Icon max "60 x 40" sign
91931	Wheeled trolley for Icon max and Icon plus

ten good reasons to choose an icon

1. Robust, high specification design for many years of trouble free advertising.
2. Simple for staff to strategically position promotions in high traffic areas.
3. Quick and easy to change posters - a one person job.
4. Modern; engaging; attention grabbing looks for maximum impact.
5. Excellent value for money and outstanding return on investment when compared to other more traditional signs.
6. Can also be used in-store to emphasise additional services.
7. Expose more customers to YOUR sales promotions.
8. Fits in with your environmental credentials - all parts are fully recyclable.
9. Extremely stable, even in severe weather conditions.
10. No loose parts that can get lost or broken.

NOTE: Hardware only no graphics included.

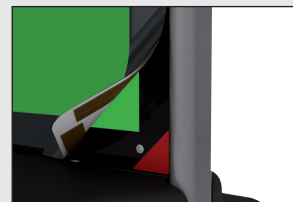

Hinged magnetic poster pocket enables graphics to be changed easily without the need for tools.



Wheeled base can be filled with sand or water for extra stability.



Recessed header for individual or corporate branding.



Poster hanging clips, holds poster in correct position.



Screw in water filler cap. Base ready filled with salt to prevent freezing.



Optional trolley for Icon max and Icon plus sizes.



snapframes

ONE-YEAR WARRANTY

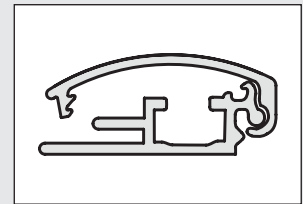

25mm profile with mitred corners.

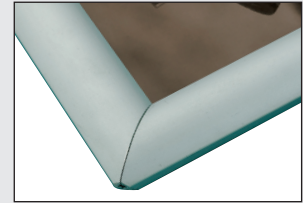

Satin anodised finish.



Frame snaps open with ease.

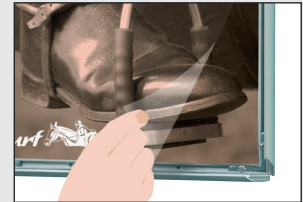

Remove protective acetate sheet.



Insert graphic or poster and snap shut.

CODE	DESCRIPTION
91720	A0 25mm profile snapframe (minimum order 5 off)
91721	A1 25mm profile snapframe (minimum order 5 off)
91722	A2 25mm profile snapframe
91723	A3 25mm profile snapframe
91724	A4 25mm profile snapframe

features

- Snap opening frames in a satin anodised finish
- Available in 5 sizes – A0, A1, A2, A3 and A4
- Single-sided wall mounted display
- Can be fitted landscape or portrait
- Comes complete with protective front covers
- Wall fixings and screws supplied as standard
- Individually boxed
- Visual area: 9mm around all edges is covered by the snapframe

N.B. For internal use only.

SNAPFRAME SIZE	POSTER SIZE	VISUAL AREA	EXTERNAL SIZE
A0	1189 x 841mm	1171 x 823mm	1219 x 871mm
A1	841 x 594mm	823 x 576mm	871 x 624mm
A2	594 x 420mm	576 x 402mm	624 x 450mm
A3	420 x 297mm	402 x 279mm	450 x 327mm
A4	297 x 210mm	279 x 192mm	327 x 240mm



NOTE: Hardware only no graphics included.



HG|Graphics

Commercial Branding Specialists

